

ual:

# Highline Building

<b>Standard Room .....</b>	<b>2</b>
<b>Premium Room (mobility adaptable) .....</b>	<b>3</b>
<b>Premium Room .....</b>	<b>4</b>
<b>Large Room .....</b>	<b>5</b>
<b>Studio (mobility adaptable) .....</b>	<b>6</b>

# ual:

## Standard Room

Typical room plan

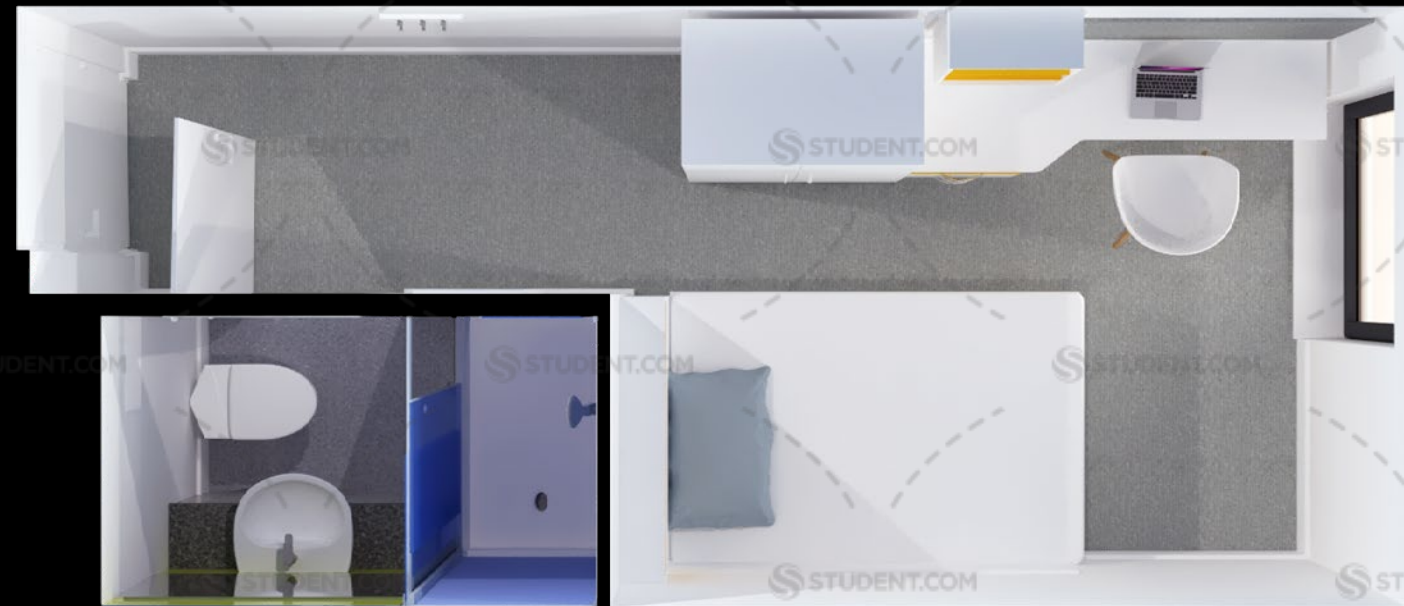

Typical room layout



# Highline Building

# ual:

## Premium Room (mobility adaptable)

Typical room plan

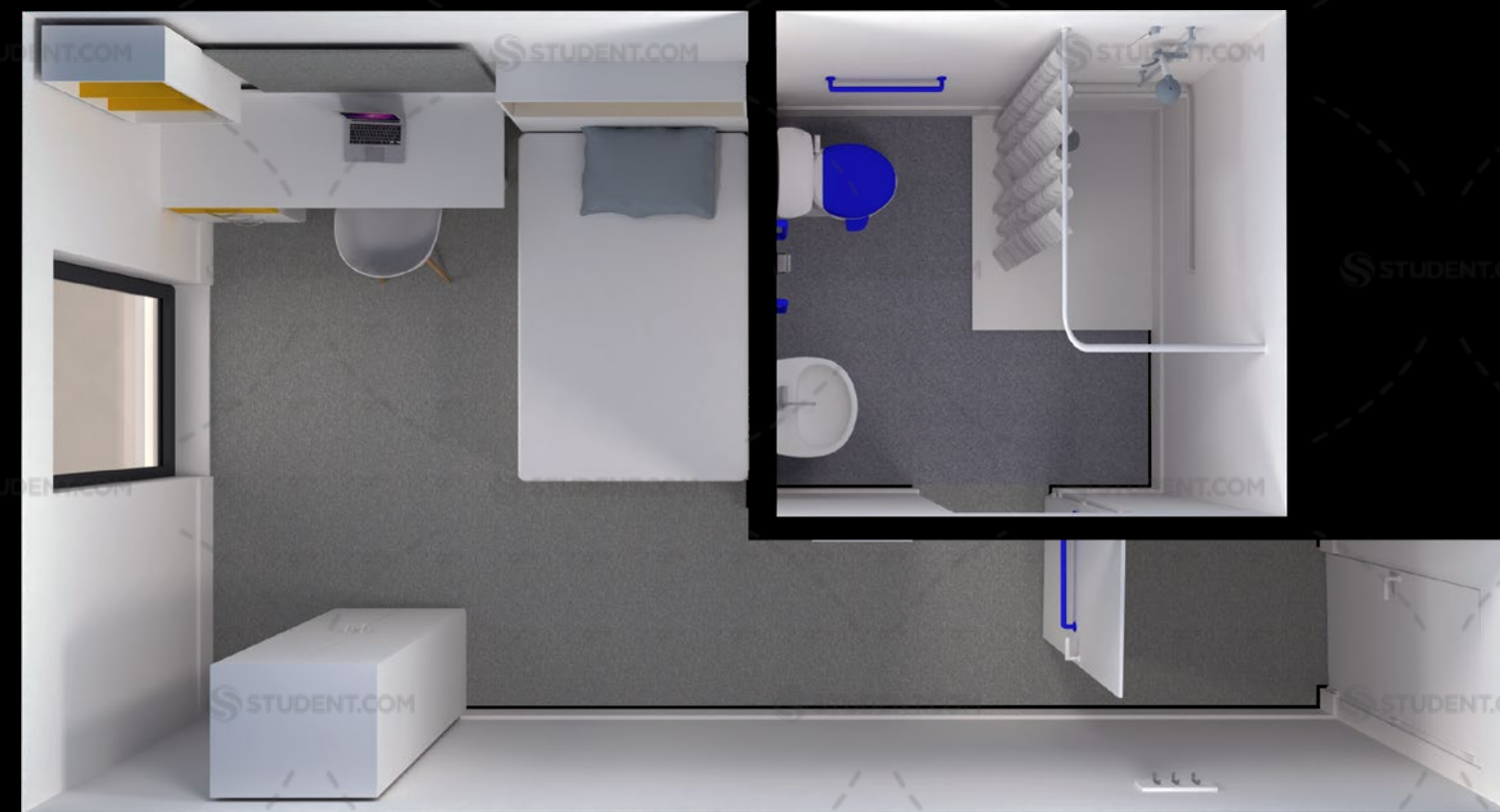

Typical room layout

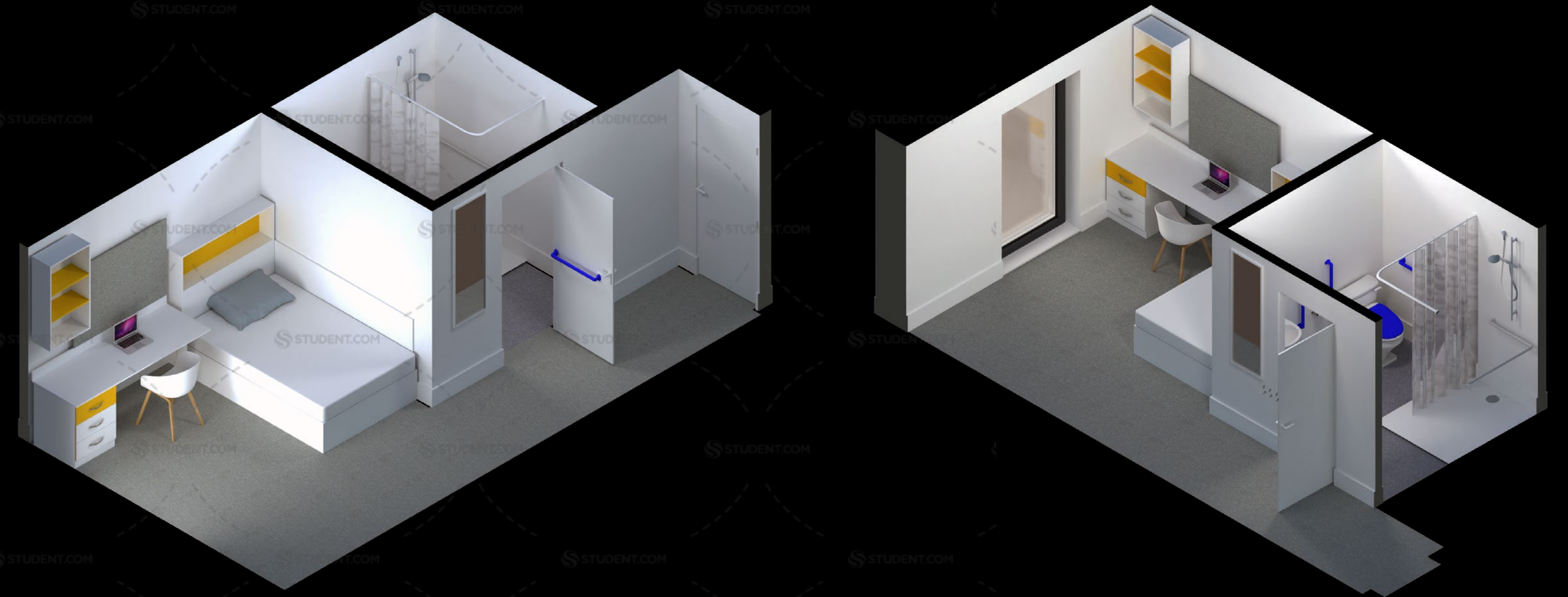

# ual:

## Premium Room

# Highline Building

Typical room plan



Typical room layout

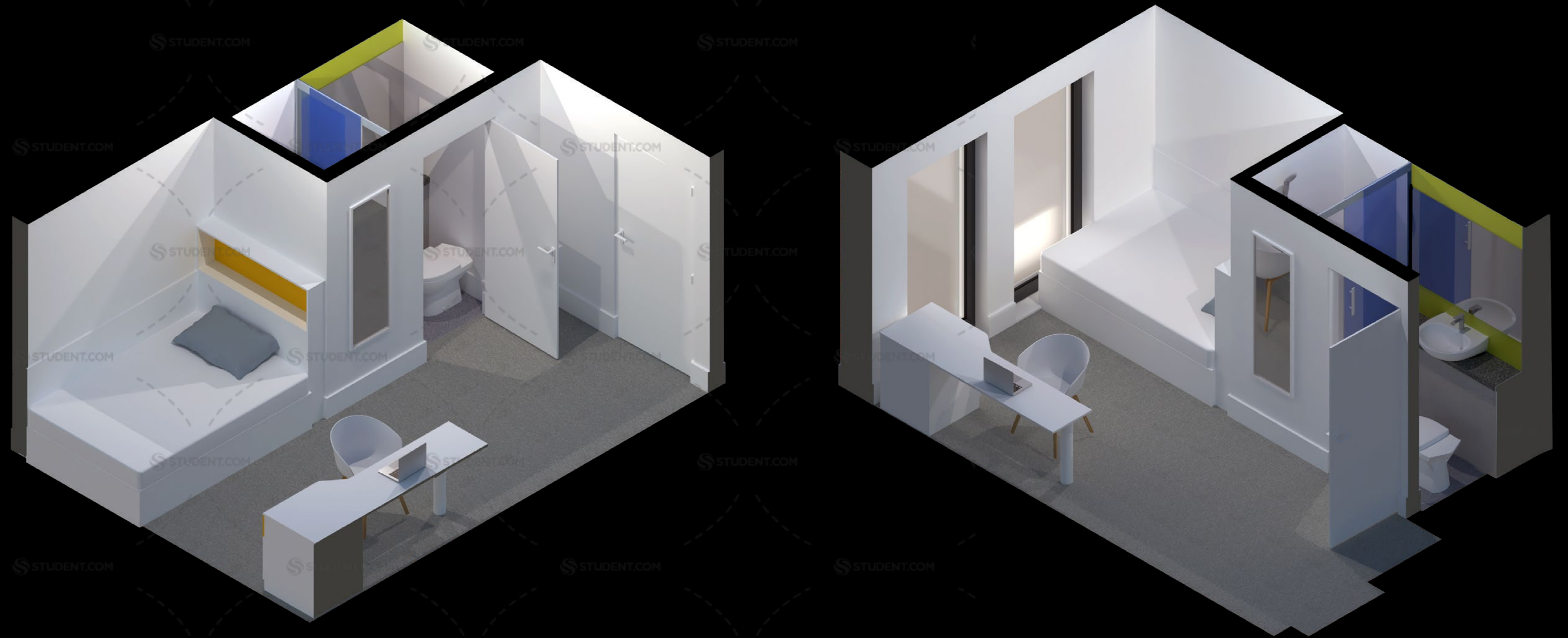

# ual:

## Large Room

# Highline Building

Typical room plan



Typical room layout



# ual:

## Studio (mobility adaptable)

# Highline Building

Typical room plan



Typical room layout

